

Classroom Select® 30" Fixed Height Desk

ASSEMBLY INSTRUCTIONS

Thank you for purchasing the Classroom Select® 30" Fixed Height Desk from School Specialty®. Please review the enclosed packing list to ensure all components are included and read the instructions carefully before you begin assembly. If you find anything missing or have any questions now or after set-up, please contact Customer Care at 888.388.3224 or customercare.schoolspecialty.com/contact-us-email.



PART AND TOOL LIST

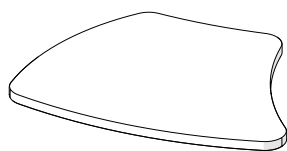
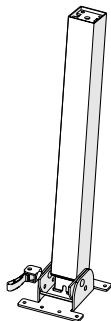
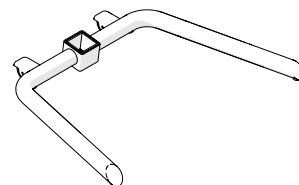

Table Top
Quantity: 1



Post
Quantity: 1



Base
Quantity: 1

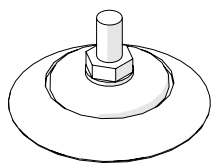

Glide
Quantity: 4

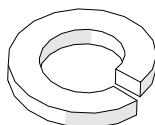

Lock Washer
Quantity: 4

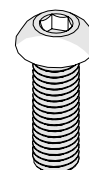

M8 x 25mm
Quantity: 4

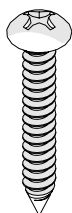

#10 x 1"
Quantity: 8

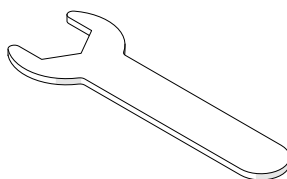

Glide Wrench
Quantity: 1

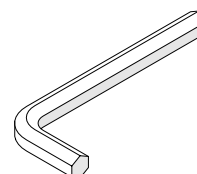

Allen Wrench
Quantity: 1

STEP 1

Screw in four (4) Glides to Base. Tighten with glide wrench.

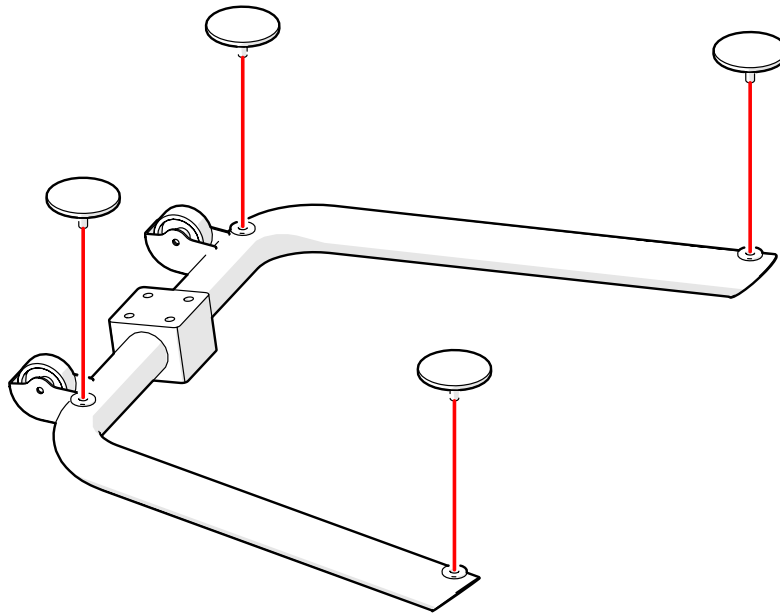

STEP 2

Insert Pneumatic Post into Base. Insert four (4) M8 x 25mm bolts through the bottom of the base with lock washers and tighten with allen wrench.

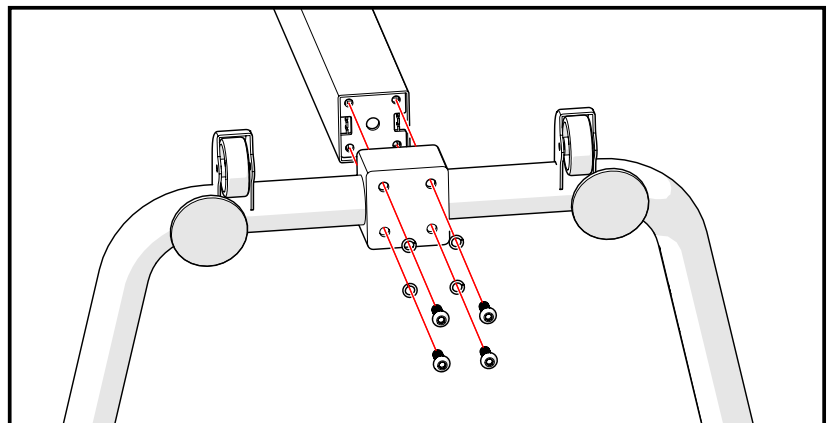
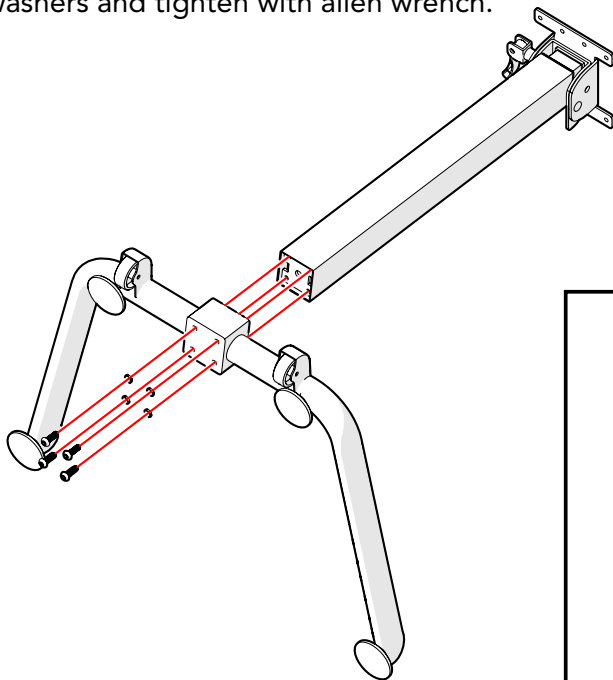

STEP 3

Place the top upside down on a stable, non-abrasive soft surface to avoid any scratching. Mount table top to post with eight (8) #10 x 1" wood screws using predrilled holes in underside of top as a guide.

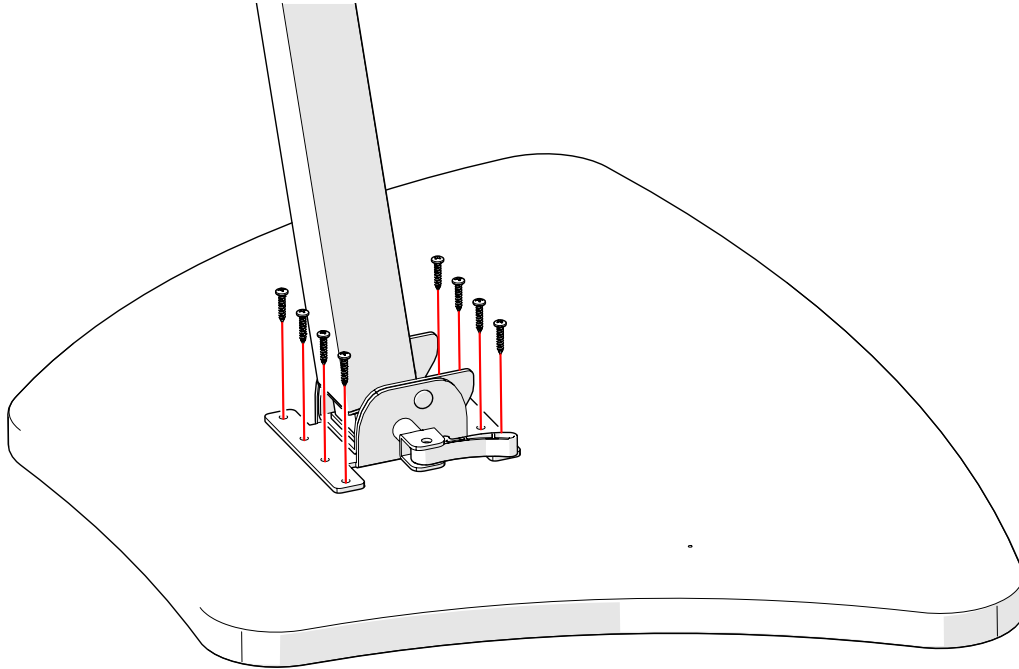

To fold table, release lever on Post and swivel top downward. When raising top, lift up from front edge. Once table top is level, push in lever to lock in place.

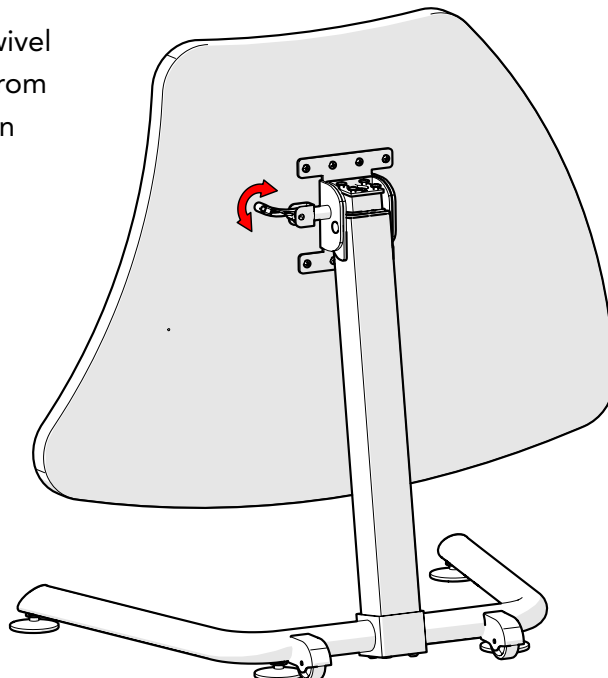

DISCLAIMERS

Please review the enclosed packing list to ensure all components are included. Please read the instructions carefully before you begin assembly. If you find anything missing or have any questions now or after set-up, please contact Customer Care at 888.388.3224 or customer care.schoolspecialty.com/contact-us-email.

Heavy or large furniture may require two or more people for proper assembly. Improper assembly may void the warranty. Ensure all hardware is correctly installed and screws are fully tightened before use. Recheck and tighten screws at least once per year. Failure to assemble or secure parts properly may result in product failure or personal injury.

The products illustrated/photographed in this assembly instruction may vary slightly from the actual product.

Product Warranty: help.schoolspecialty.com/s/article/Product-Warranties