

# Classroom Select® Mobile Power Tower

## ASSEMBLY INSTRUCTIONS

Thank you for purchasing the Classroom Select® Mobile Power Tower from School Specialty®. Please review the enclosed packing list to ensure all components are included and read the instructions carefully before you begin assembly. If you find anything missing or have any questions now or after set-up, please contact Customer Care at 888.388.3224 or [customer care.schoolspecialty.com/contact-us-email](mailto:customer care.schoolspecialty.com/contact-us-email).

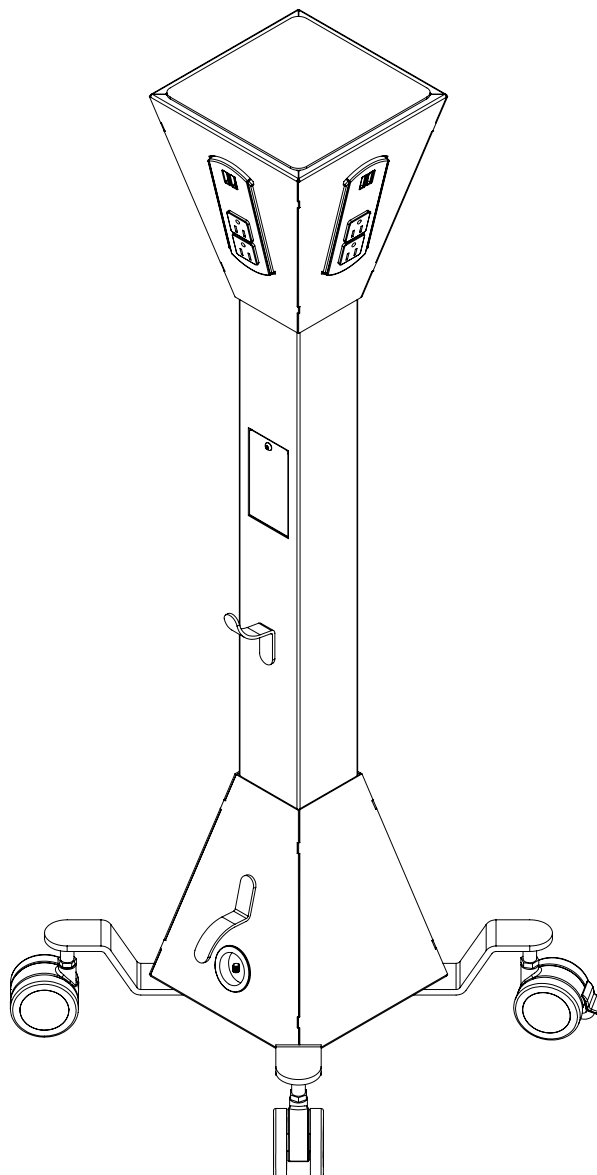

## PART AND TOOL LIST

---

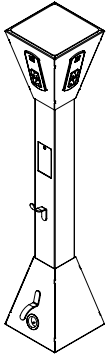

Power Tower  
Quantity: 1

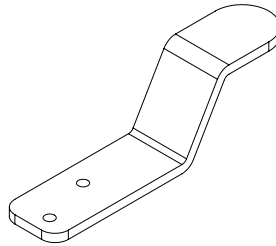

Foot  
Quantity: 4

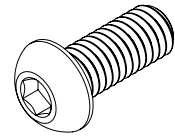

M6-1.0 Socket Screw  
Quantity: 8

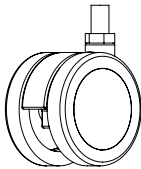

Caster  
Quantity: 2

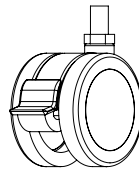

Locking Caster  
Quantity: 2

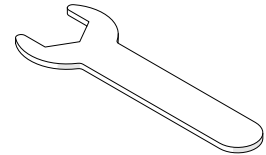

Caster Wrench  
Quantity: 1

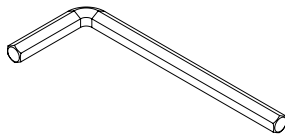

Allen Wrench  
Quantity: 1

## STEP 1

Attach a Foot to the bottom of the Power Tower using two M6-1.0 Socket Screws. Tighten the Screws using an Allen Wrench. Repeat for the other three Feet.

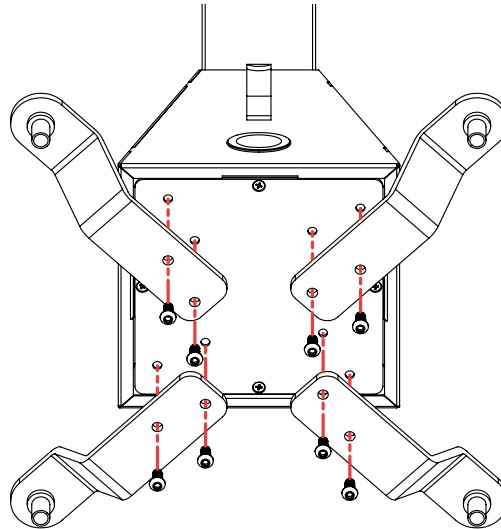

## STEP 2

Thread then tighten one Caster into each Foot. Place the two Locking Casters next to each other for best results.

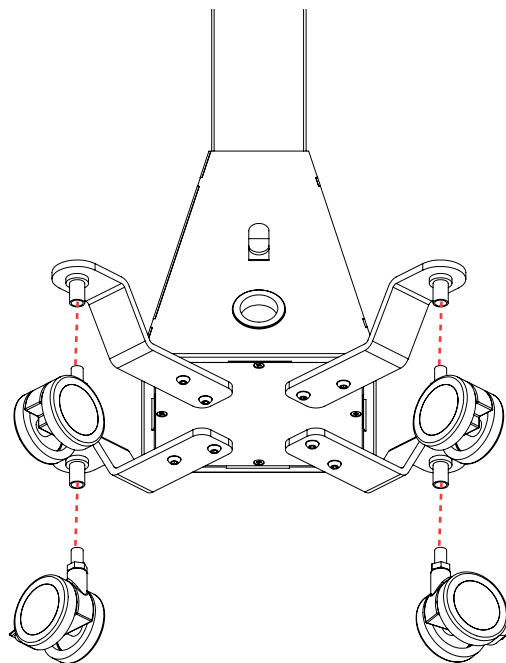

## RESET SWITCH

---

Unscrew the small panel on the Power Tower to reveal the red Reset Switch.

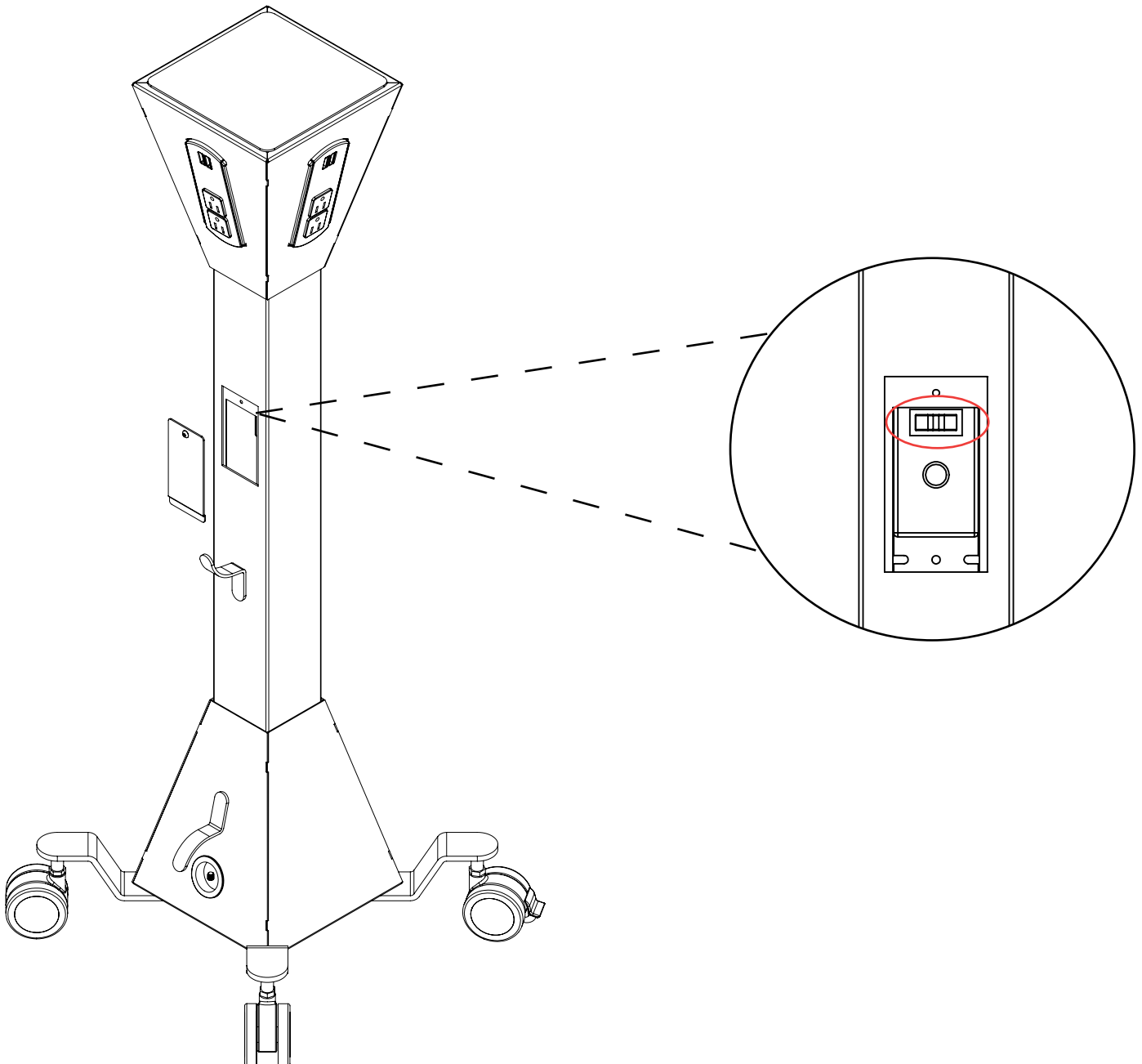

## DISCLAIMERS

---

Please review the enclosed packing list to ensure all components are included. Please read the instructions carefully before you begin assembly. If you find anything missing or have any questions now or after set-up, please contact Customer Care at 888.388.3224 or [customer care.schoolspecialty.com/contact-us-email](mailto:customer care.schoolspecialty.com/contact-us-email).

Heavy or large furniture may require two or more people for proper assembly. Improper assembly may void the warranty. Ensure all hardware is correctly installed and screws are fully tightened before use. Recheck and tighten screws at least once per year. Failure to assemble or secure parts properly may result in product failure or personal injury.

The products illustrated/photographed in this assembly instruction may vary slightly from the actual product.

**Product Warranty:** [help.schoolspecialty.com/s/article/Product-Warranties](https://help.schoolspecialty.com/s/article/Product-Warranties)