

# Big Red Base Assembly Instructions

## Introduction

The Big Red Base System is the foundation for all sport net games and is sold as individual components or complete sets.

### INDIVIDUAL COMPONENTS

- Item# 1478910 Big Red Base with Casters
- Item# 018588 Short Post Only (41" - 66" height)
- Item# 1004657 Tall Post Only (61" - 96" height)
- Item# 1583374 Replacement Cone

### COMBO SETS

- Item# 006322 Big Red Base & Short Post Combo
- Item# 004406 Big Red Base & Tall Post Combo

## Assembly for Base & Posts

1. Insert red cone (2) into the center of the base (1), with the fill cap pointed up.
2. Push down red cone (2) by applying downward force until there is no gap between the cone wings and base.
3. Insert bottom post (5) into the red cone (2), and lock in place with the bolt (3) and nut(4).
4. Slide top post (6) into bottom post (5), and lock into place using push pin.
5. Insert eye bolt (7) through the top hole of the top post (6), and lock with wing nut (8).
6. Press in push pin, and slide until desired height is locked into position (see marking on poles for official height positions).
7. Fill base before use.

### Fill Recommendations

- Wet Sand: 83+ lbs.
- Pea Gravel: 72+ lbs.
- Dry Sand: 68+ lbs.
- Water: 50+ lbs.

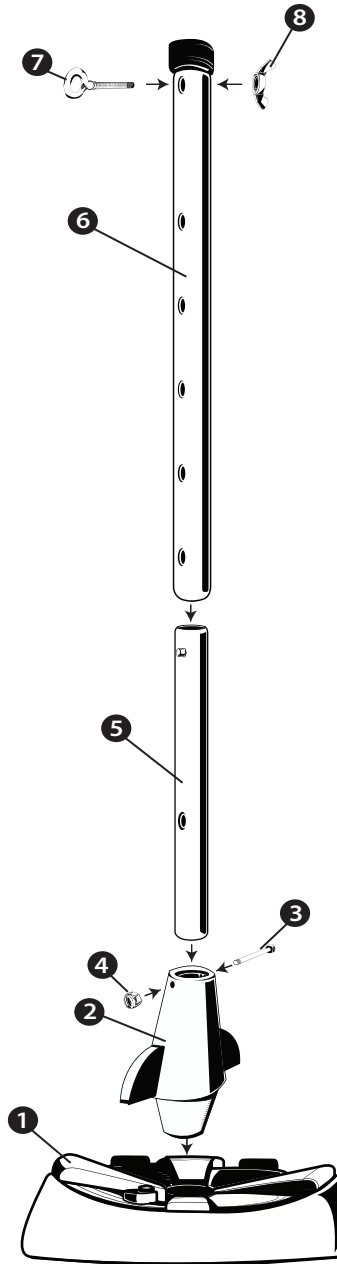

## Net Attachment

Items# 004352, 008564, 008566 (Sold Separately)

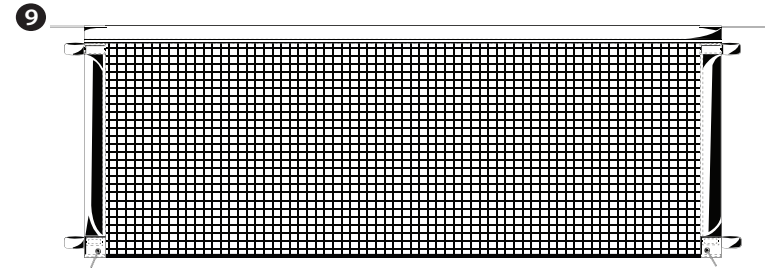

1. Attach post to the Big Red Base and fill base according to the recommended instructions.
2. Unroll net (9), and spread out for assembly.
3. Slide red hook and loop straps over top post (6), ensuring the top of the net (9) has the yellow Sportime logo.
4. Pull white strings at the top of the net so the net is flat and straight.
5. Tie the top white strings around the eye hook (7), securing the net.
6. Press in push pin and slide top post (6) until desired height is locked into desired height.