

Classroom Select® NeoClass® Teacher Table

ASSEMBLY INSTRUCTIONS

Thank you for purchasing the Classroom Select® NeoClass® Teacher Table from School Specialty®. Please review the enclosed packing list to ensure all components are included and read the instructions carefully before you begin assembly. If you find anything missing or have any questions now or after set-up, please contact Customer Care at 888.388.3224 or customer care.schoolspecialty.com/contact-us-email.

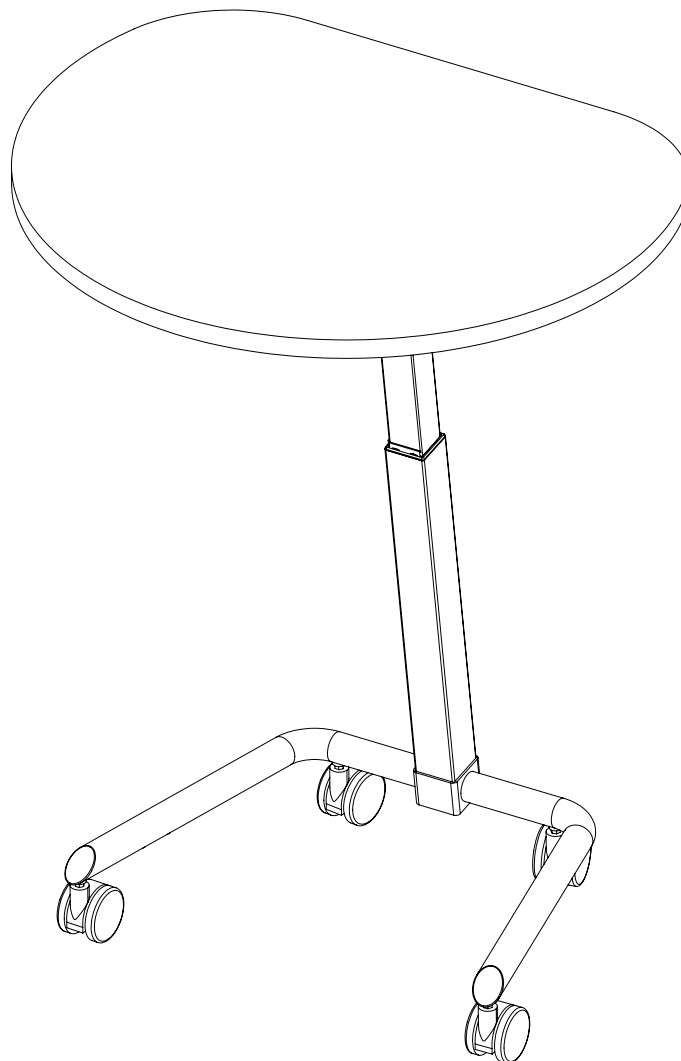

PART AND TOOL LIST

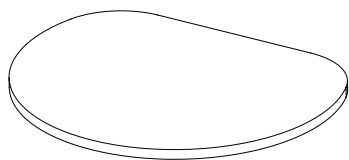

Top Panel
Quantity: 1

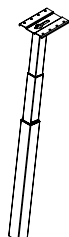

Pneumatic Post
Quantity: 1

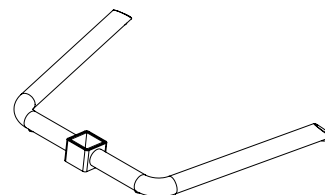

Base
Quantity: 1

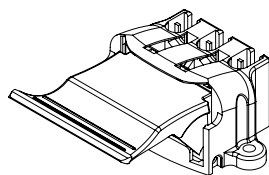

Handle
Quantity: 1

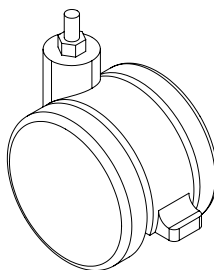

Casters
Quantity: 4

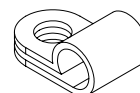

Cable Tie
Quantity: 1

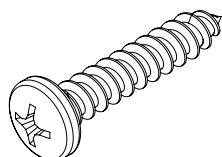

No. 10 x 1" Wood Screw
Quantity: 13

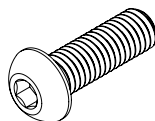

M8 x 25mm Hex Screw
Quantity: 4



Lock Washer
Quantity: 4

PART AND TOOL LIST

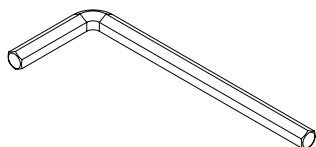

Hex Screw
Quantity: 1

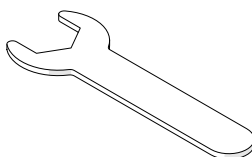

Caster Wrench
Quantity: 1

STEP 1

Screw in four Casters to Base. Tighten with Caster Wrench.

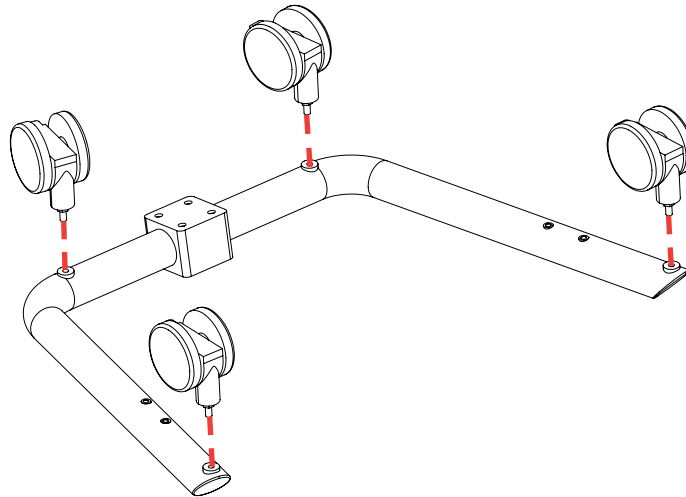

STEP 2

Insert Pneumatic Post into Base. Insert four M8 x 25mm Hex Screws through the bottom of the Base with Lock Washers and tighten with Allen Wrench.

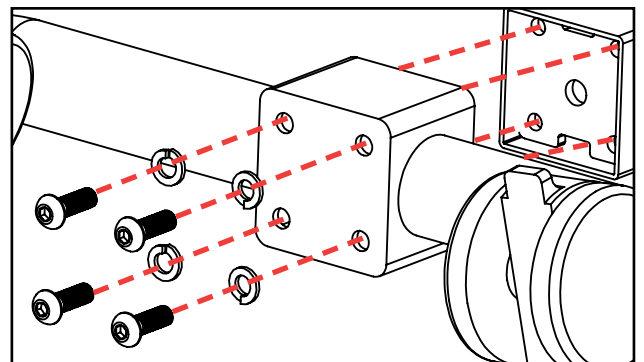
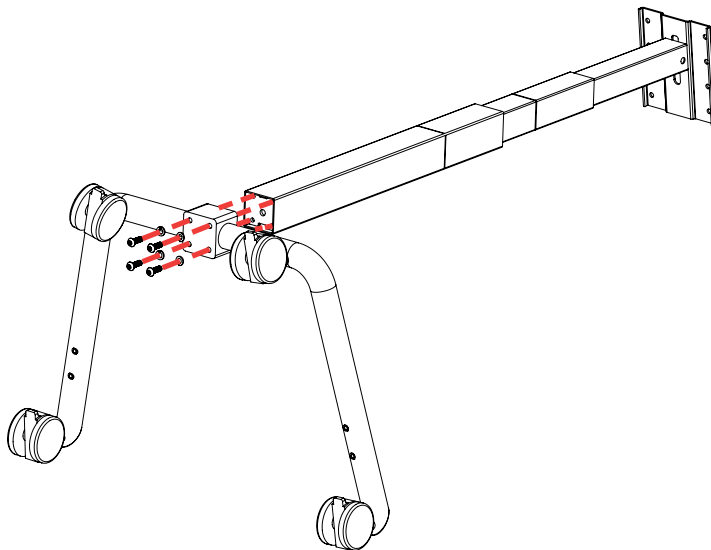

STEP 3

Place the top upside down on a stable, non-abrasive soft surface to avoid any scratching. Mount Table Top to Post with eight #10 x 1" Wood Screws using predrilled holes in underside of Table Top as a guide.

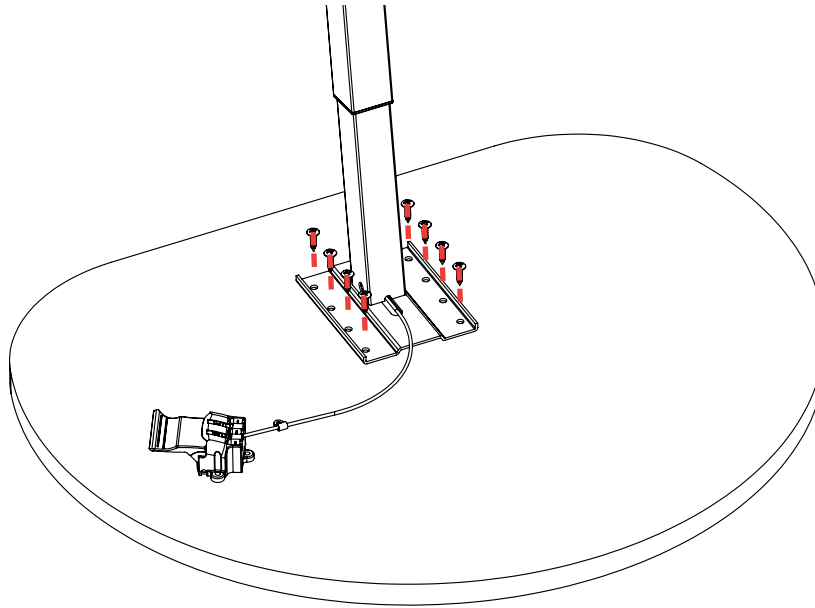

STEP 4

Attach the Handle to Table Top with three #10 x 1" Wood Screws using predrilled holes in underside of Table Top as a guide.

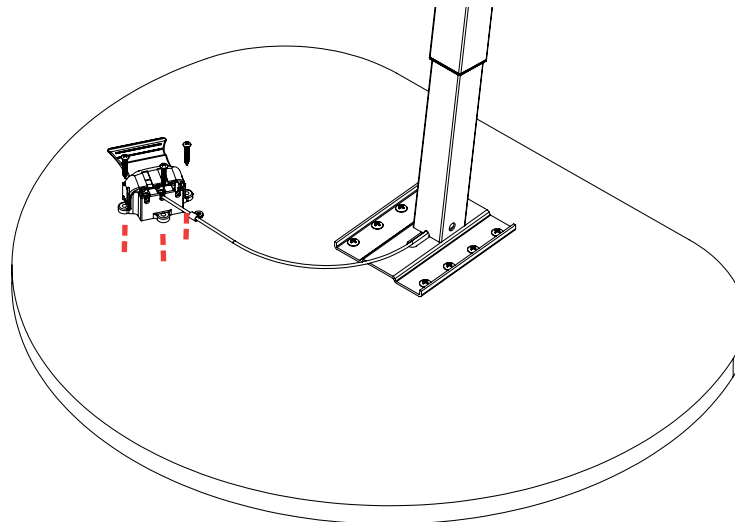

STEP 5

Attach the Cable Tie to Table Top with one #10 x 1" Wood Screw. Use the Cable Tie to position the cable as desired.

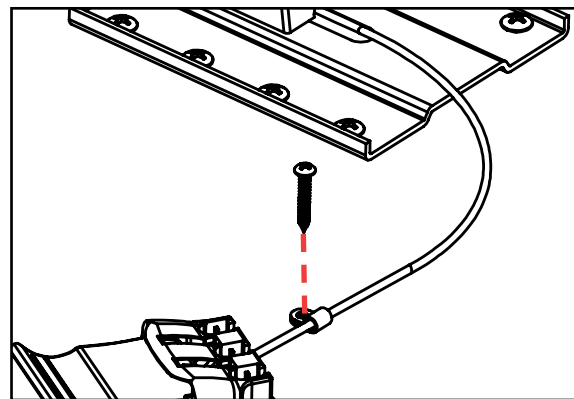
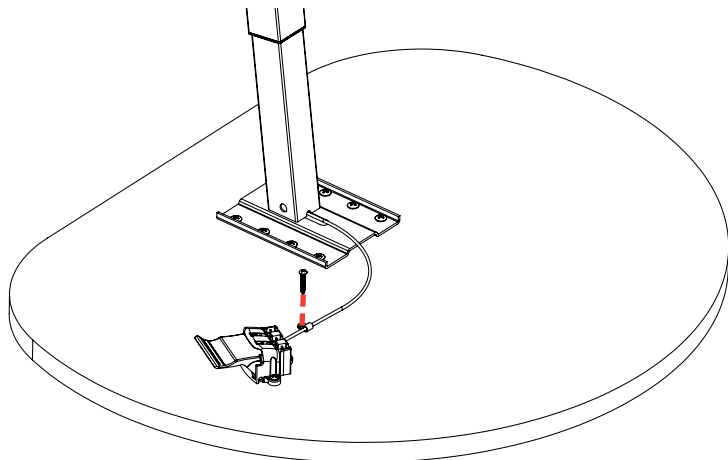

DISCLAIMERS

Please review the enclosed packing list to ensure all components are included. Please read the instructions carefully before you begin assembly. If you find anything missing or have any questions now or after set-up, please contact Customer Care at 888.388.3224 or customercare.schoolspecialty.com/contact-us-email.

Heavy or large furniture may require two or more people for proper assembly. Improper assembly may void the warranty. Ensure all hardware is correctly installed and screws are fully tightened before use. Recheck and tighten screws at least once per year. Failure to assemble or secure parts properly may result in product failure or personal injury.

The products illustrated/photographed in this assembly instruction may vary slightly from the actual product.

Product Warranty: help.schoolspecialty.com/s/article/Product-Warranties