

Classroom Select® Flipper Table

ASSEMBLY INSTRUCTIONS

Thank you for purchasing the Classroom Select® Flipper Table from School Specialty®. Please review the enclosed packing list to ensure all components are included and read the instructions carefully before you begin assembly. If you find anything missing or have any questions now or after set-up, please contact Customer Care at 888.388.3224 or customer care.schoolspecialty.com/contact-us-email.

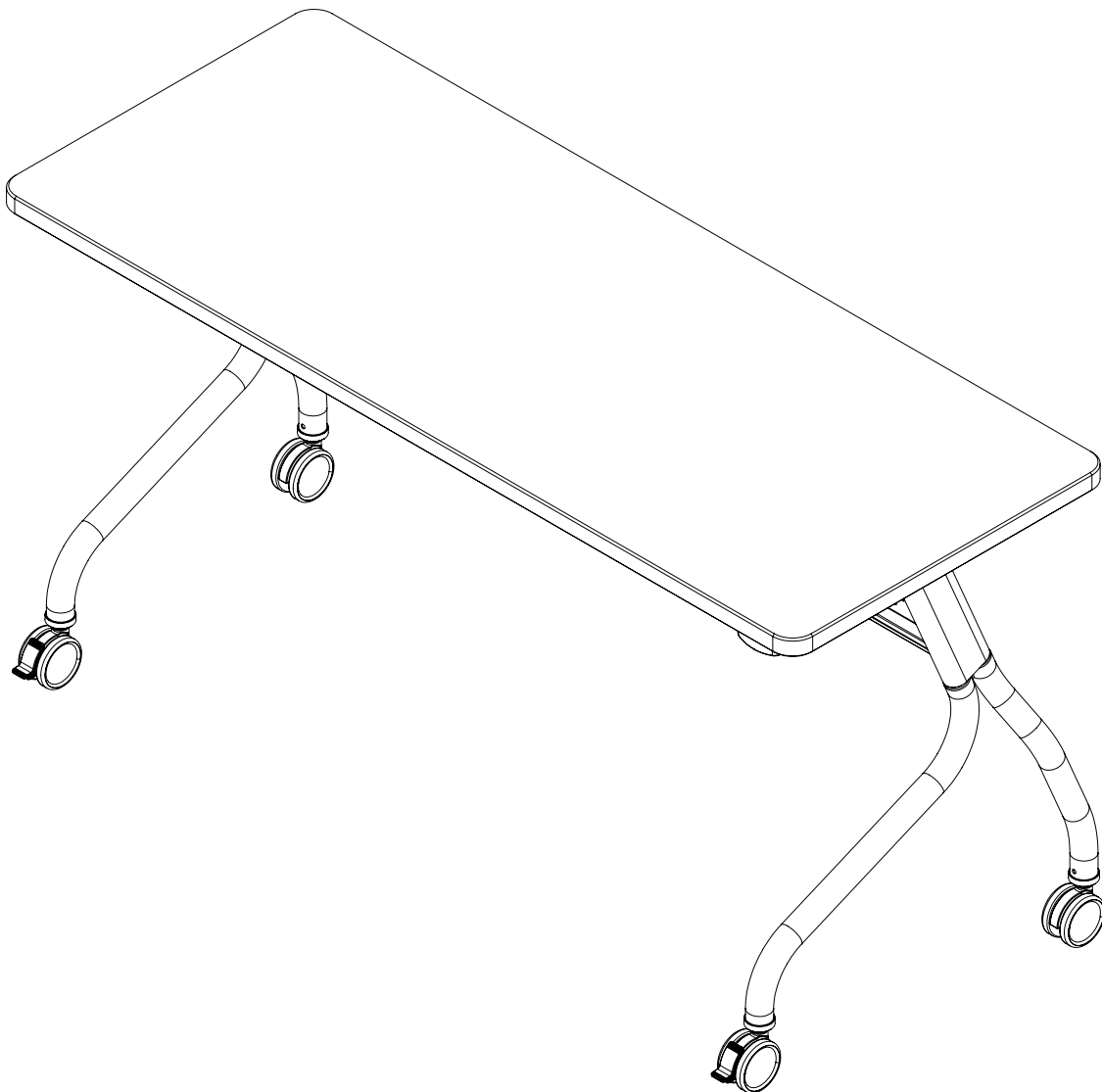

PART AND TOOL LIST

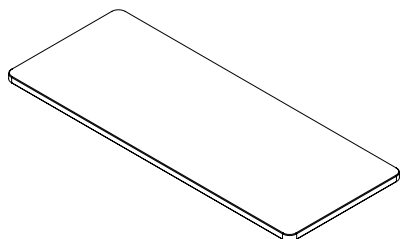
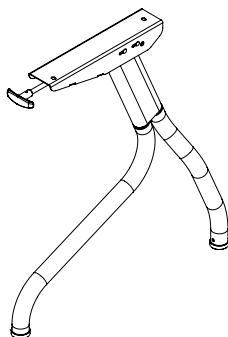
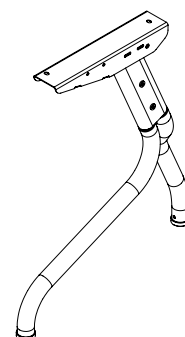

Table Top
Quantity: 1



Right Leg
Quantity: 1



Left Leg
Quantity: 1

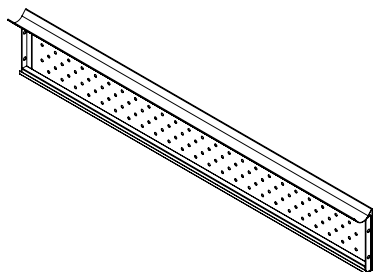

Modesty Panel
Quantity: 1

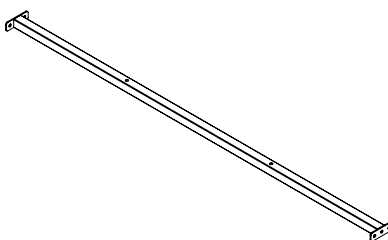

Top Support
Quantity: 1

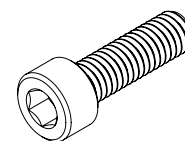

M6x20mm Socket Screw
Quantity: 4

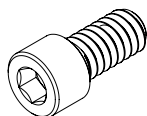

1/4x12mm Socket Screw
Quantity: 8

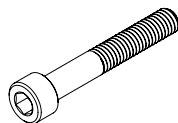

M6x38mm Socket Screw
Quantity: 2

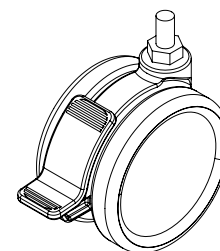

2" Locking Caster
Quantity: 2

PART AND TOOL LIST

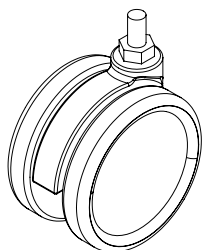

2" Caster
Quantity: 2

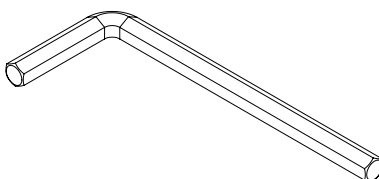

Allen Wrench
Quantity: 1

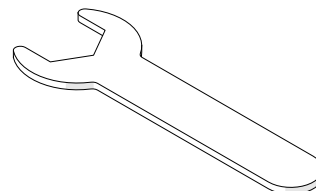

Caster Wrench
Quantity: 1

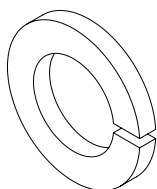

Lock Washer-Caster
Quantity: 4

STEP 1

Place the Table Top upside down on a stable, non-abrasive soft surface to avoid any scratching. Place the Left Leg over the embedded threaded inserts in the bottom of the Table Top. Attach the Left Leg to the Table Top using two M6x20mm Socket Screws.

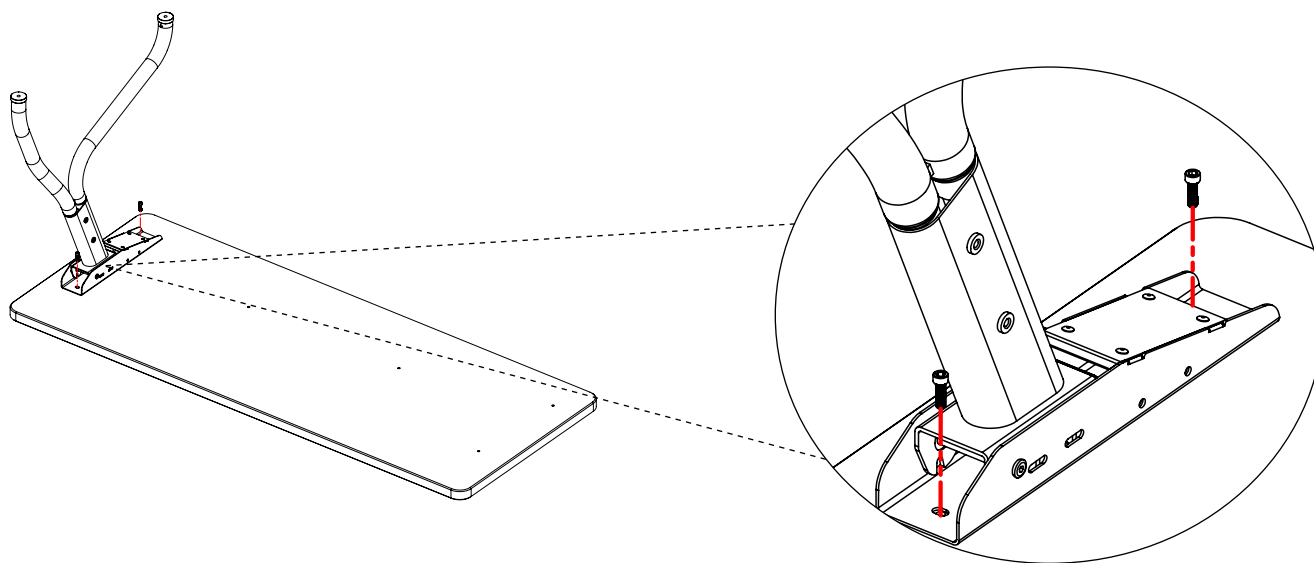

STEP 2

Attach the Top Support to the Left Leg using two ¼x12mm Socket Screws. Use two M6x38mm Socket Screws to attach the Top Support to the Table Top.

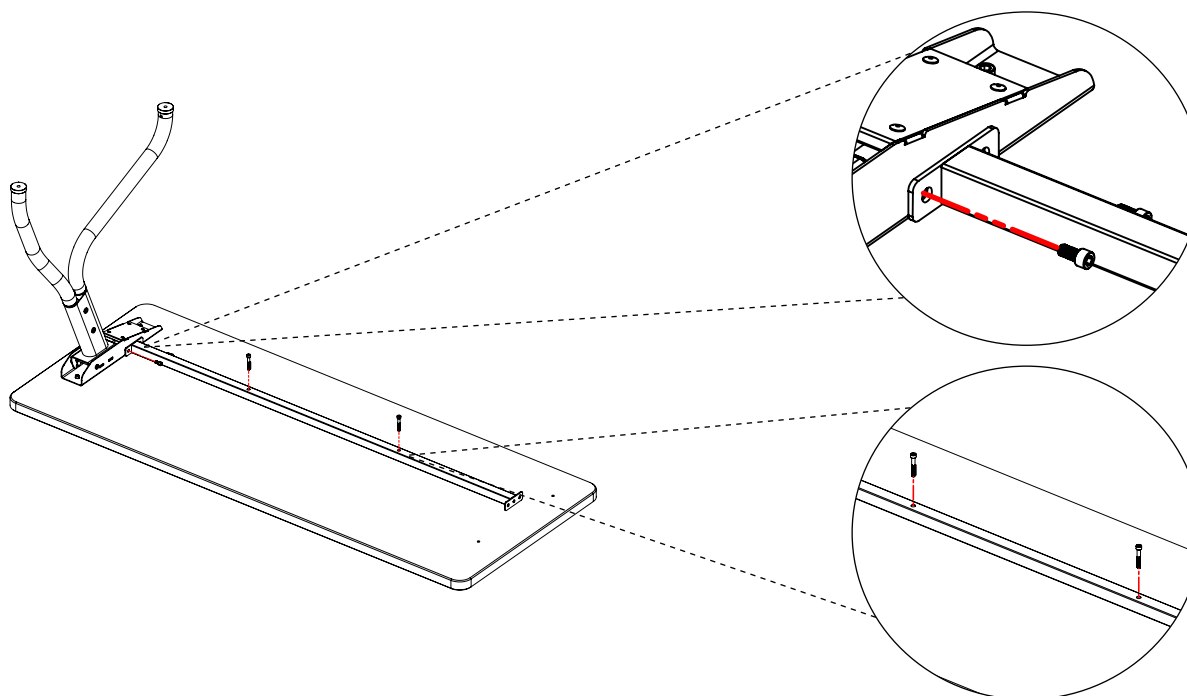

STEP 3

Place the Right Leg over the embedded threaded holes in the bottom of the Table Top. Secure the Right Leg to the Table Top using two M6x20mm Socket Screws. Attach the Top Support to the Right Leg using two ¼x12mm Socket Screws.

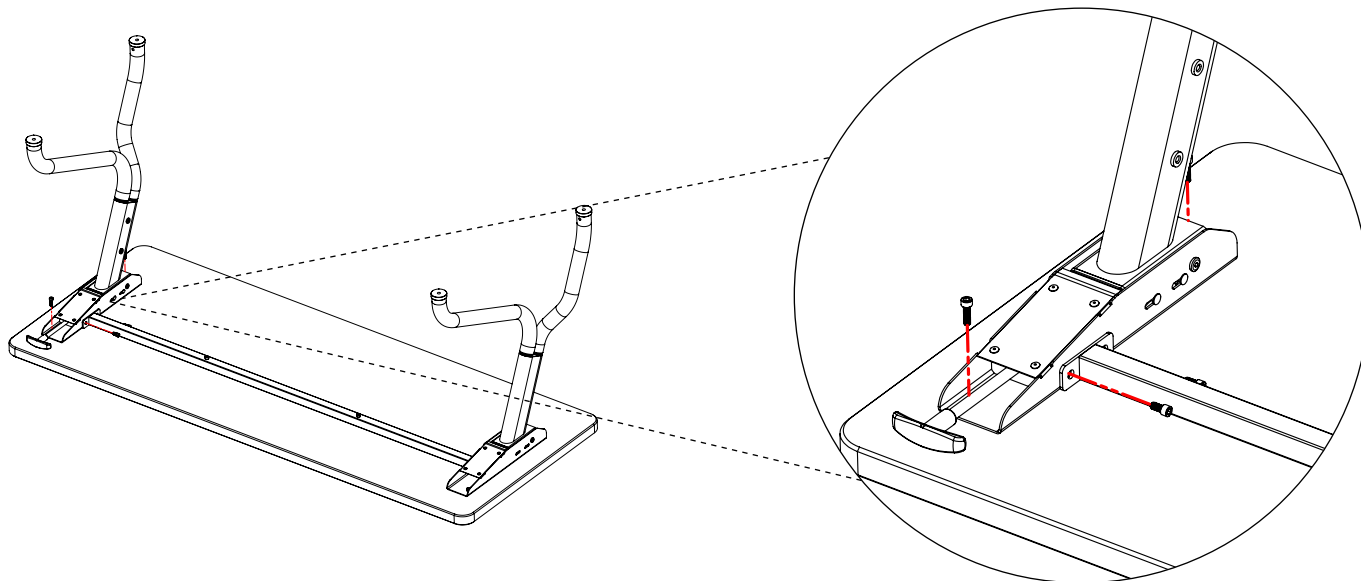

STEP 4

Attach the Modesty Panel to the inside of the Left Leg and the Right Leg. Use two ¼x12mm Socket Screws to secure the panel to each leg.

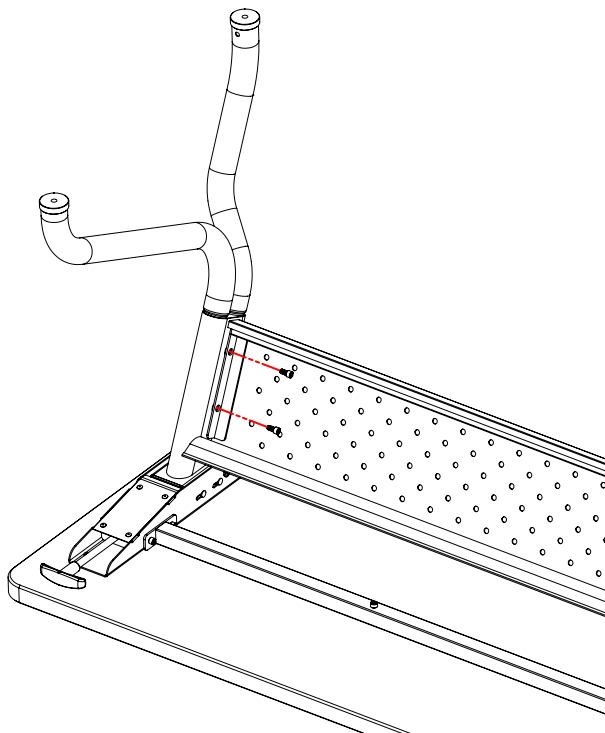

STEP 5

Place a Lock Washer on each Caster and screw into the back holes in the bottom of the Right and Left Legs. Place a Lock Washer on each Locking Caster and screw into the front holes in the bottom of the Right and Left Legs. Tighten all Casters with the Caster Wrench.

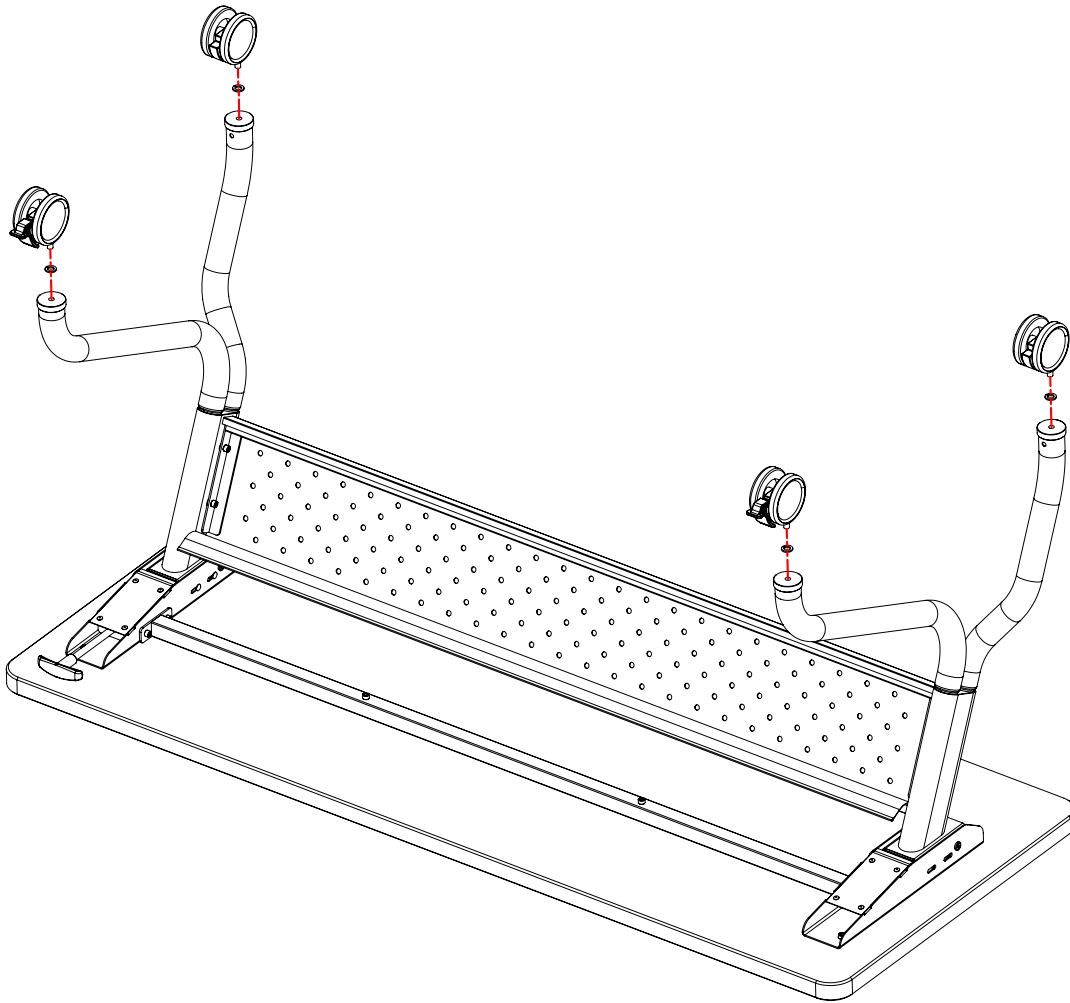

DISCLAIMERS

Please review the enclosed packing list to ensure all components are included. Please read the instructions carefully before you begin assembly. If you find anything missing or have any questions now or after set-up, please contact Customer Care at 888.388.3224 or customercare.schoolspecialty.com/contact-us-email.

Heavy or large furniture may require two or more people for proper assembly. Improper assembly may void the warranty. Ensure all hardware is correctly installed and screws are fully tightened before use. Recheck and tighten screws at least once per year. Failure to assemble or secure parts properly may result in product failure or personal injury.

The products illustrated/photographed in this assembly instruction may vary slightly from the actual product.

Product Warranty: help.schoolspecialty.com/s/article/Product-Warranties