

Classroom Select® Construct-IT

ASSEMBLY INSTRUCTIONS

Thank you for purchasing Classroom Select® Construct-IT from School Specialty®. Please review the enclosed packing list to ensure all components are included and read the instructions carefully before you begin assembly. If you find anything missing or have any questions now or after set-up, please contact Customer Care at 888.388.3224 or customer care.schoolspecialty.com/contact-us-email.

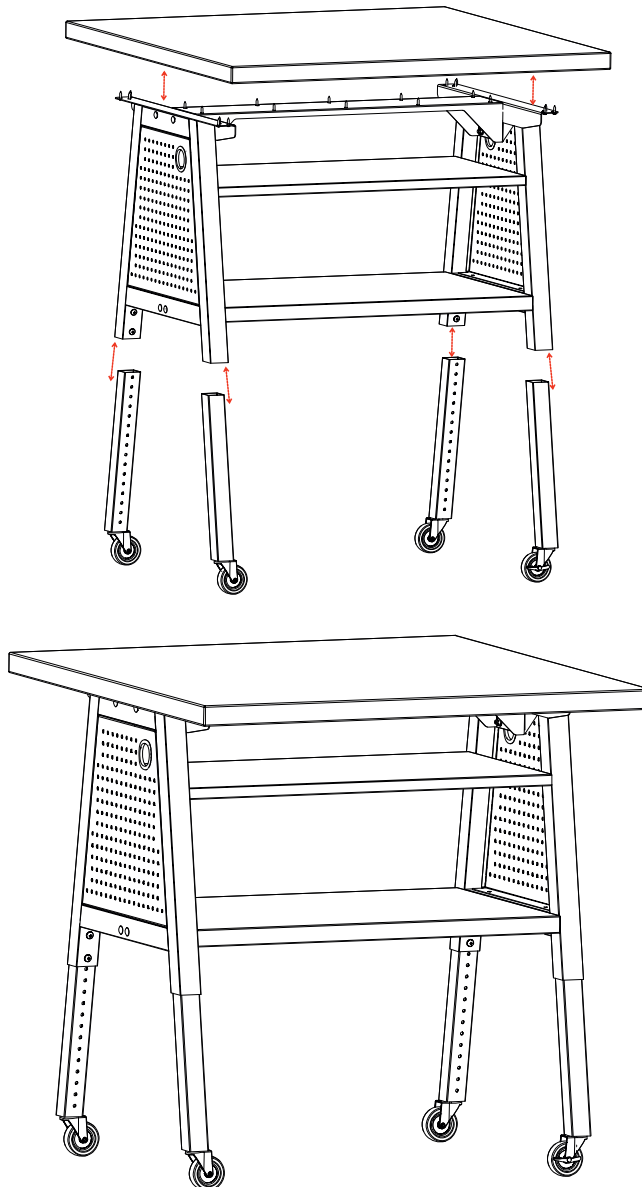

PART AND TOOLS LIST

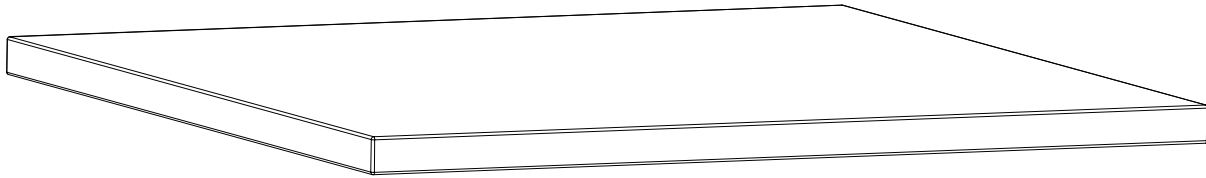

Laminate or Butcher Block Top
Quantity: 1

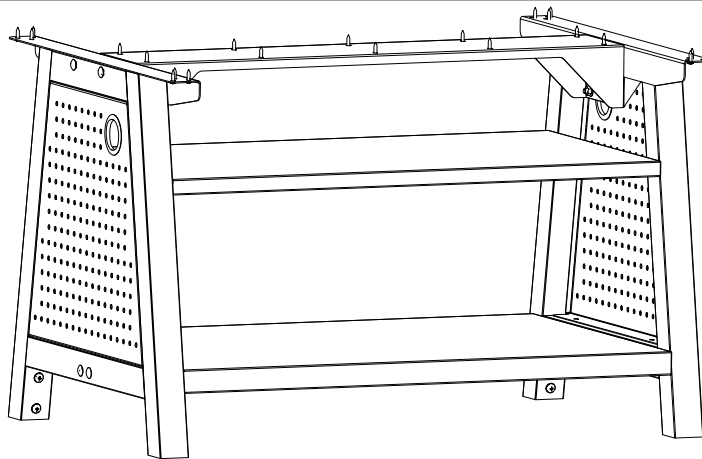

Construct-IT Frame
Quantity: 1

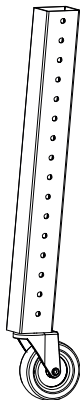

Leg Insert
Quantity: 4

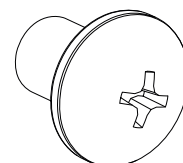

Leg Insert Screw
Quantity: 8

STEP 1

To begin the installation, place the top upside down on a stable, non-abrasive soft surface to avoid any scratching with the mounting brackets facing upward, ensuring proper alignment. Next, position the frame over the designated mounting areas, aligning the pre-drilled holes on the base with those on the bottom flange of the frame. Once aligned, use the provided screws to securely fasten the frame to the top, tightening each screw evenly to ensure stability. After securing the screws, perform a final inspection to confirm that the frame is firmly attached and properly aligned. Ensuring all components are securely fastened will provide a stable foundation for the next steps in the assembly process.

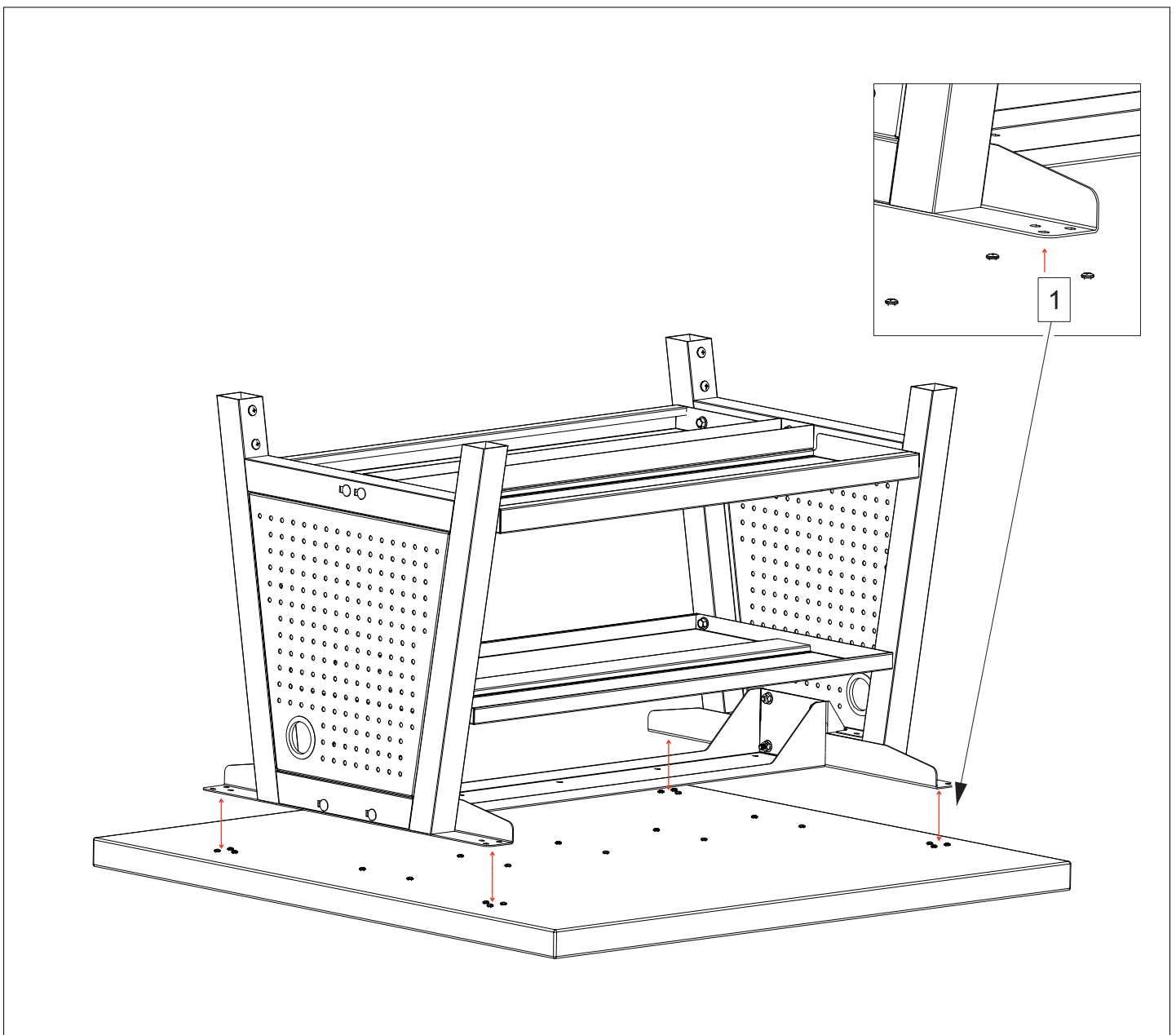

STEP 2

In this step of the installation, the leg inserts are inserted into the pre-installed frame on the base. Begin by aligning the leg insert (labeled as 1) with the open end of the corresponding support pole, ensuring that the adjustment holes are properly aligned for height customization. Carefully slide the leg insert down into the support pole, making sure it fits securely. Next, as shown in the detailed view (labeled as 2), insert and fasten the locking bolts to secure the leg insert in place. Ensure that the height adjustment holes are correctly positioned before tightening the bolts. Once all 4 leg inserts are properly inserted and secured, verify their alignment and stability.

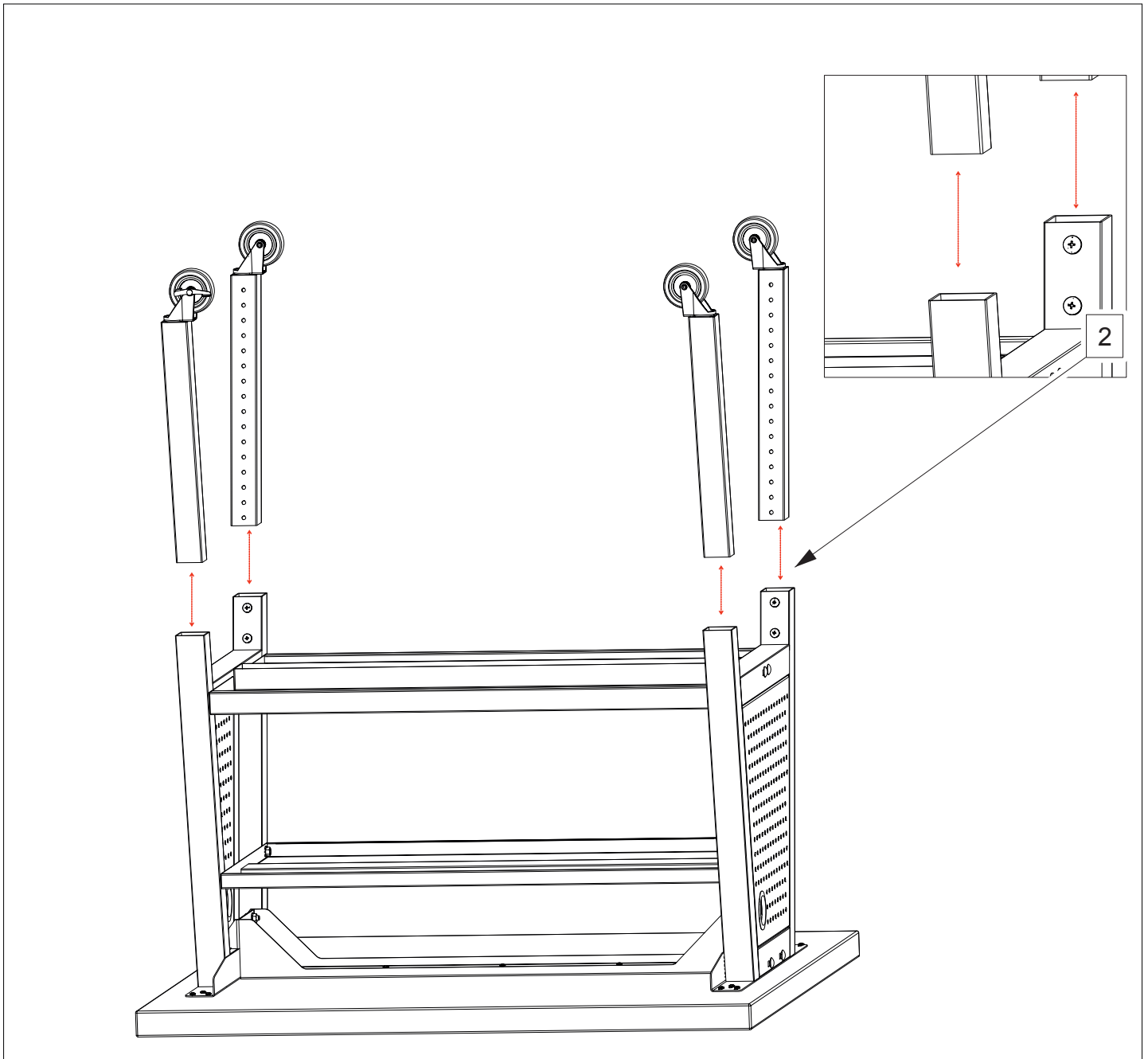

STEP 3

Using two people, carefully flip the table over to its upright position. Ensure that all legs are securely locked in place and that the table is stable before use.

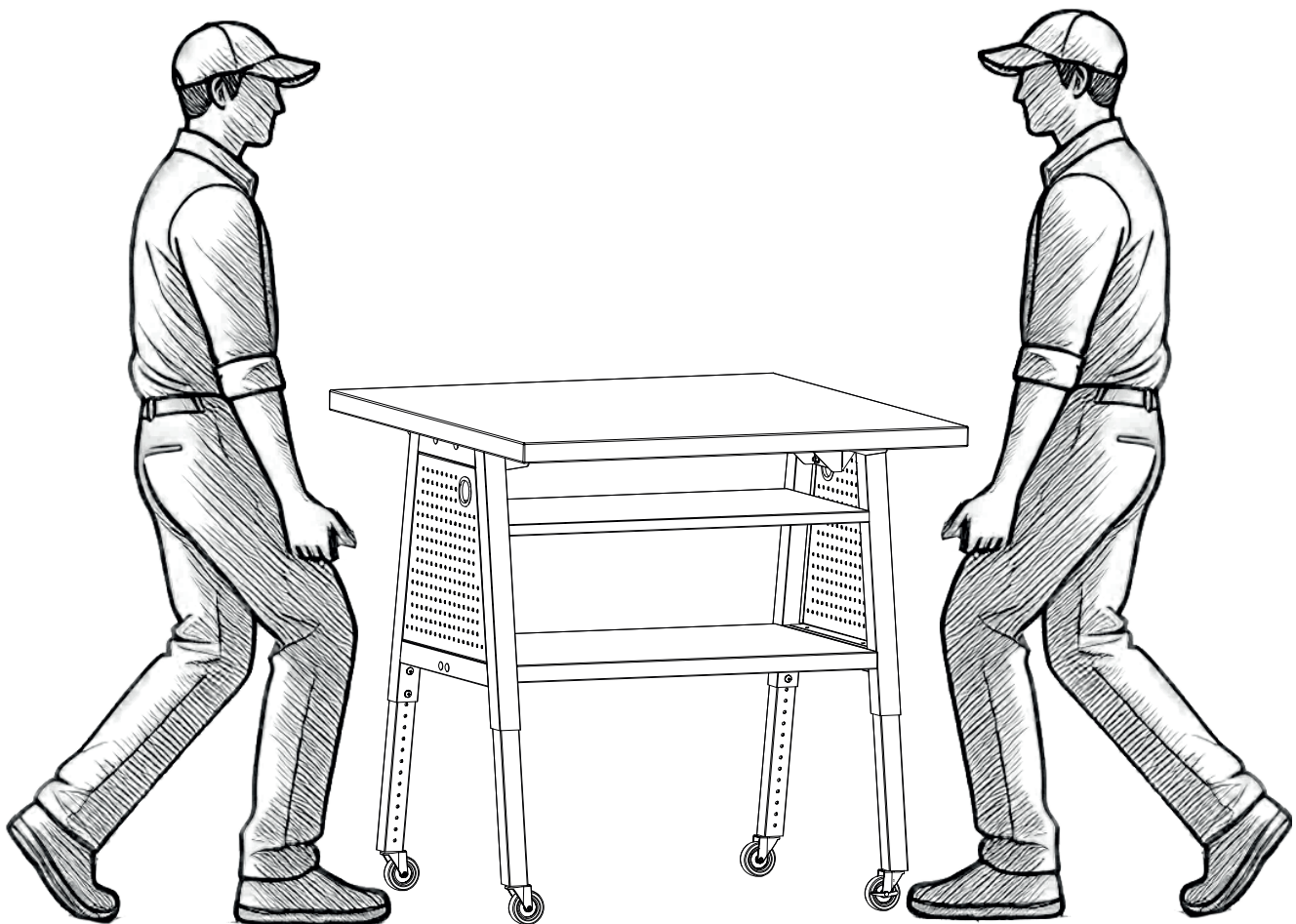

DISCLAIMERS

Please review the enclosed packing list to ensure all components are included. Please read the instructions carefully before you begin assembly. If you find anything missing or have any questions now or after set-up, please contact Customer Care at 888.388.3224 or customercare.schoolspecialty.com/contact-us-email.

Heavy or large furniture may require two or more people for proper assembly. Improper assembly may void the warranty. Ensure all hardware is correctly installed and screws are fully tightened before use. Recheck and tighten screws at least once per year. Failure to assemble or secure parts properly may result in product failure or personal injury.

The products illustrated/photographed in this assembly instruction may vary slightly from the actual product.

Product Warranty: help.schoolspecialty.com/s/article/Product-Warranties